

San Francisco Recreation & Parks Department
Eastern Neighborhoods CAC
RPD Update
August 19, 2019



Inspire, Connect, Play!



Investing in San Francisco Parks

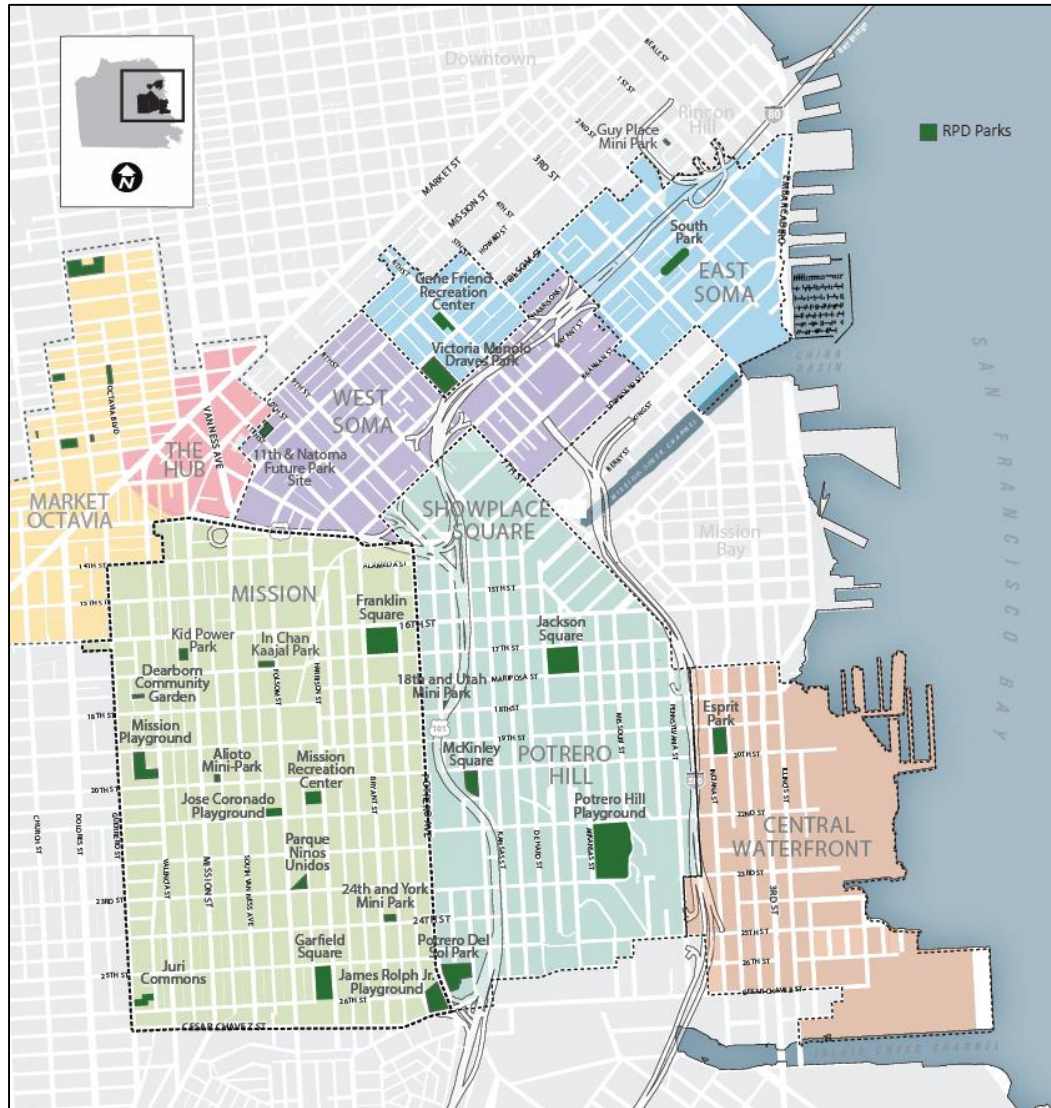

Active Projects in the Eastern Neighborhoods

SoMa/East Cut

- 11th & Natoma
- Gene Friend Rec Center
- Guy Place Mini Park
- Victoria Manalo Draves Park

Potrero Hill/Showplace Square

- Jackson Playground
- Potrero Hill Rec Center

Dogpatch/Central Waterfront

- Esprit Park

Mission

- Franklin Square
- Garfield Pool
- James Rolph Jr. Playground
- Jose Coronado Playground
- Juri Commons
- Mission Rec Center



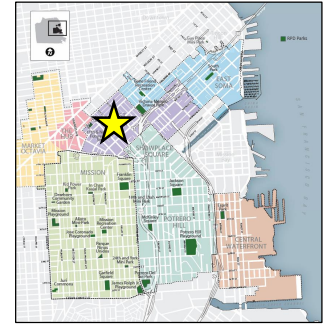

Natoma Street Frontage



Minna Street Frontage

Impact Fee Funding:
\$8,810,000

Open Space Acquisition Funding:
\$9,725,000



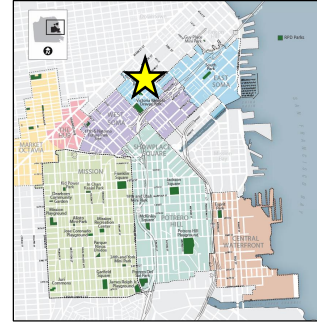

Total Project Budget:
TBD

Impact Fee Funding:
\$2,800,000

TPL in-kind services:
\$500,000

Project Elements

- Increase indoor space by 1.5x
- 2 courts, 3 multi-purpose room
- Larger exercise room
- All new playground, outdoor court & other amenities





VIEW FROM CORNER OF SIXTH & FOLSOM
GENE FRIEND RECREATION CENTER

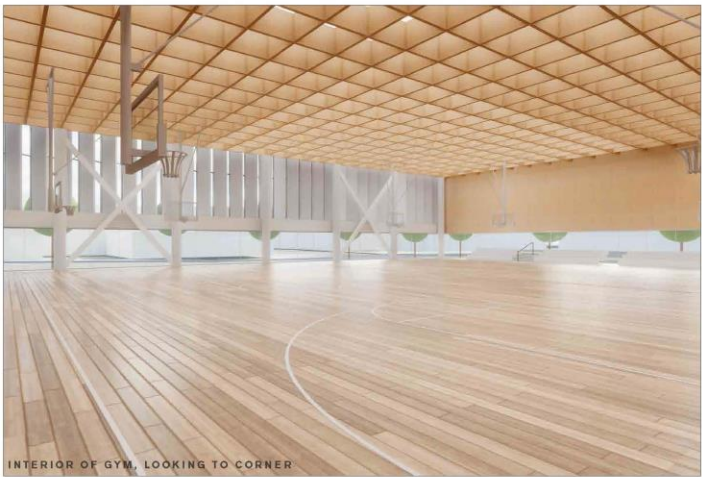

WRNSSTUDIO



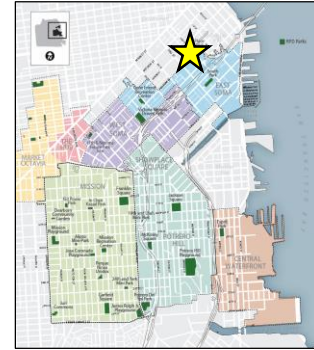

Total Project Budget:

\$5,300,000

Impact Fees: Addback:

\$5,240,000 \$60,000

Project Elements

- Design characterized by 3 outdoor “rooms”
- An artist-designed fence
- A pet fountain and permeable dog relief area

Planning
February 2014

Design
January 2015

Bid/Award
December 2017

Construction
August 2018

Opening
October 2019





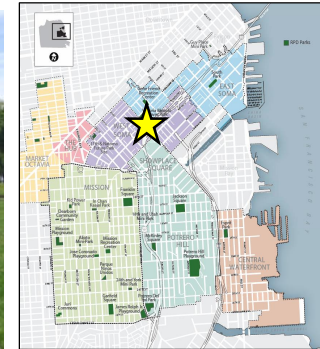

Total Project Budget:

\$2,600,000

Impact Fees (from Intercontinental):

\$2,600,000

Improvements Include:

- Lighting upgrades to the ballfield, basketball court and pathways
- Additional seating and improved site circulation
- Expansion of the community garden with added planters

Planning
July 2018

Design
July 2019

Bid/Award
October 2019

Construction
February 2020

Opening
June 2020







Total Project Budget:

TBD

Impact Fees:

\$1,640,000

FOJP/Developers:

\$4,500,000 pledged

\$2,000,000 secured

Improvements May Include:

- Reconfigure existing use into a coherent/functional use
- Refine site circulation
- Create passive spaces
- New CPA and courts
- Renovate historic clubhouse

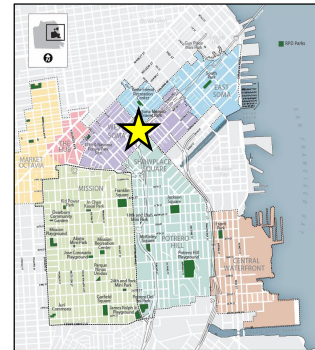
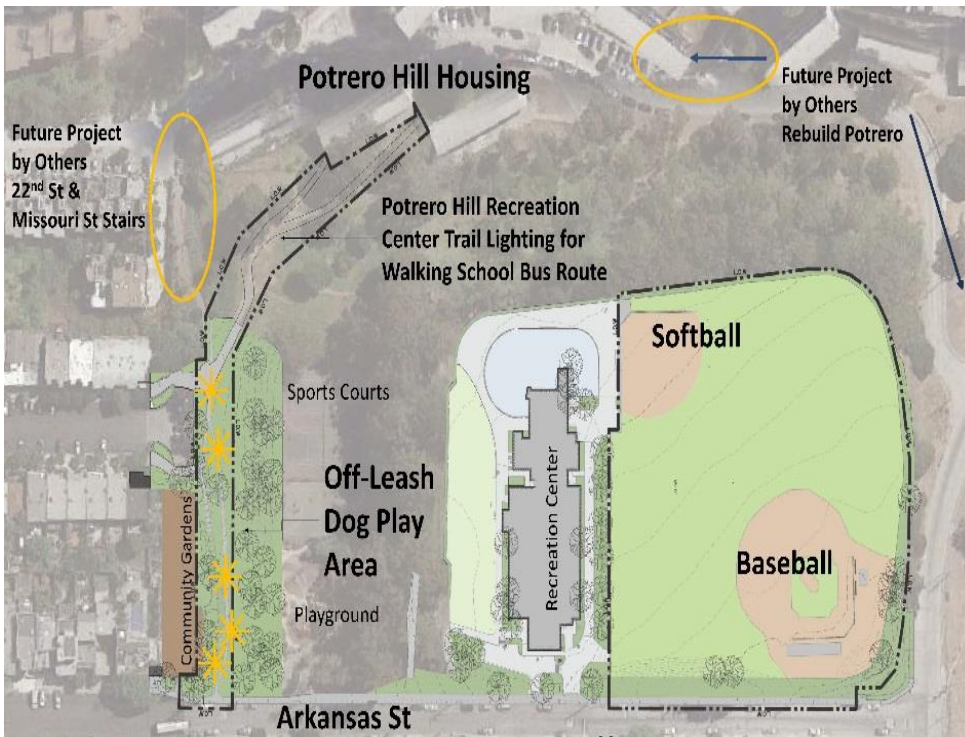

Total Project Budget:

\$5,530,000

GO Bond:
\$4,000,000

Impact Fees:
\$1,330,000

General Fund:
\$200,000

Improvements Include:

- Improvements to the natural turf playfields and lower level dog play area
- Lighting upgrades at on-site pathway for the Walking School Bus Route

Planning
April 2015

Design
December 2016

Bid/Award
February 2018

Construction
July 2018

Opening
Late August
2019





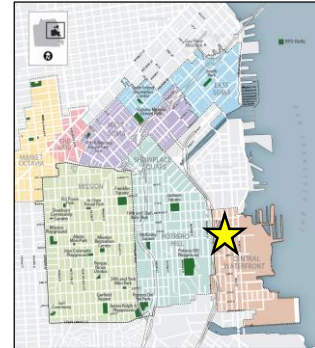

Total Project Budget:

\$7,735,000

Impact Fees:

\$2,700,000

UCSF Donation:

\$5,000,000

General Fund:

\$35,000

Project Elements

- Playground & pathway upgrades
- Defined space for dogs
- Clarifying functional use areas
- Refining park circulation

Planning
October 2017

Design
October 2019

Bid/Award
September 2020

Construction
February 2021

Opening
March 2022



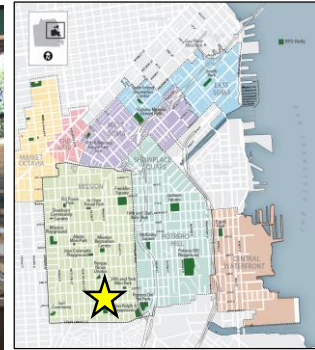
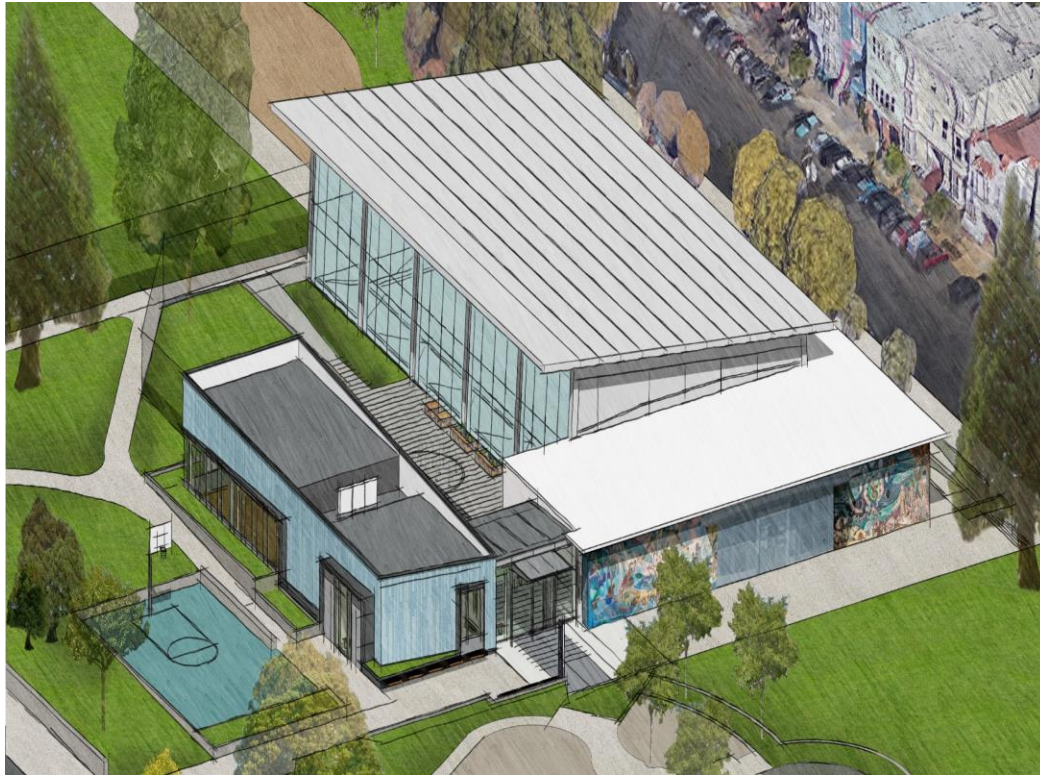

Total Project Budget:

\$20,064,000

GO Bond:

\$11,000,000

Impact Fees:

\$8,738,000

Open Space:

\$326,000

Improvements Include:

- 40% additional capacity
- New shallow space for kids
- 50% more space in multi-purpose room
- New courtyard for additional programming
- New murals + refurbishing existing



Planning
January 2015

Design
June 2017

Bid/Award
May 2018

Construction
November 2018

Opening
May 2020





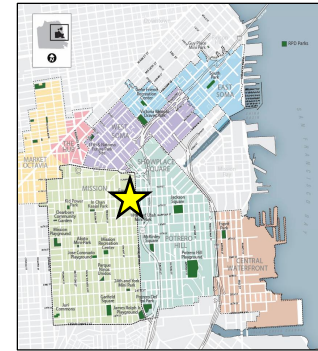

Total Project Budget:

\$235,000

Addback: Impact Fees:

\$25,000 \$210,000

Improvements Include:

- ADA Accessibility
- Concrete seat wall to delineate edge of equipment
- Additional lighting
- Parcourse Equipment
- Replacement of pathway along Bryant Street

Planning
August 2015

Design
July 2017

Bid/Award
August 2018

Construction
August 2018

Opening
August 2019



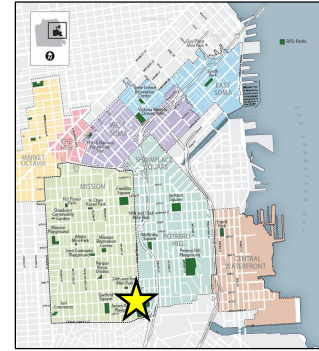

Deferred Maintenance/Improvements Include:

- Resurfacing and upgrades to tennis court
- Repainting basketball courts
- Improvements and additional fencing around baseball field

Timeline

- **Project complete!**
- Courts reopened in July 2017

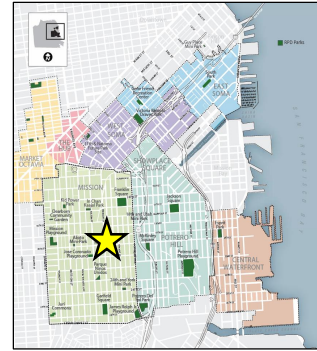

Deferred Maintenance/Improvements Include:

- Resurfacing and upgrades to tennis and basketball courts, and soccer pitch
- Replacement of fencing and repainting

Impact Fee Funding:

\$1,869,000 over FY19, FY 20 & FY 21

With this Operations capital improvement, there are no immediate needs at this site.

Timeline

- **Project complete!**
- Courts reopened in May 2018



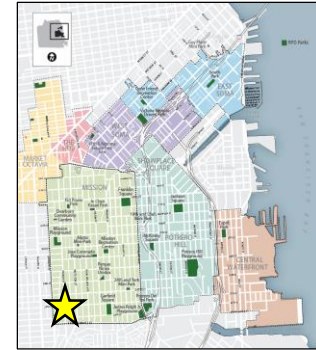
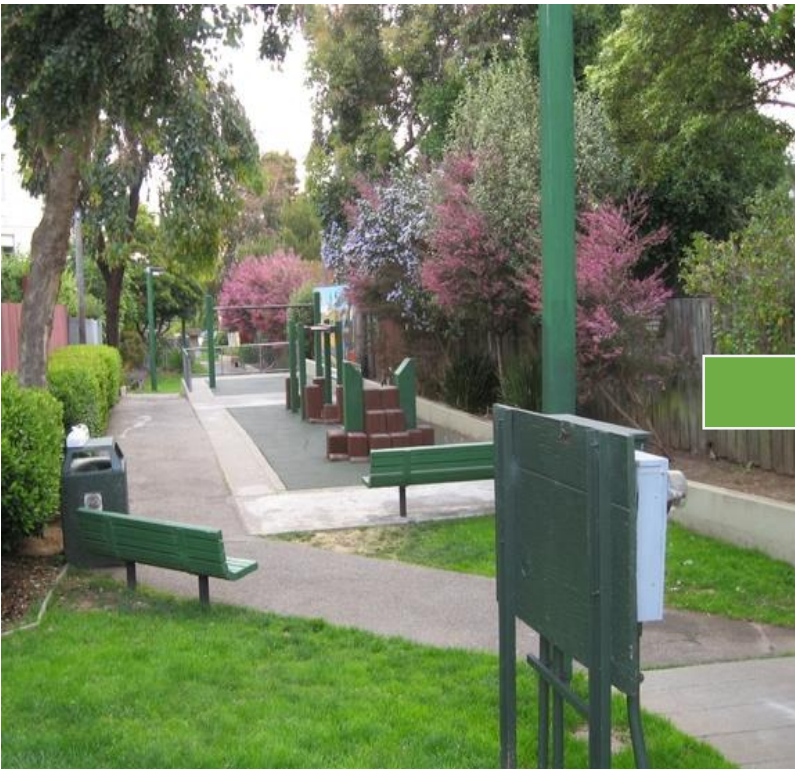

Total Project Budget:

\$1,600,000

Impact Fees:

\$825,000

Bond:

\$524,000

Let'sPlaySF!:

\$75,000

\$175,000 requested

Project Elements

- New playground
- Improved accessible circulation
- New Adult exercise
- Verdant landscaping & multi-use lawn
- Varied seating options
- Adding reference to historic railroad

Planning
April 2018

Design
September 2018

Bid/Award
October 2019

Construction
February 2020

Opening
August 2020



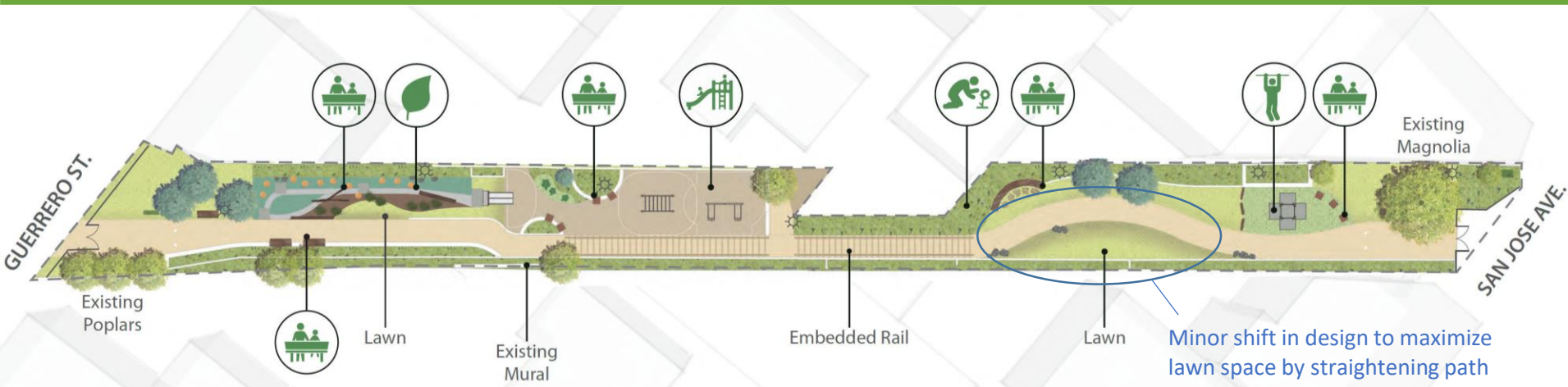

Looking from Guerrero



Looking towards Guerrero



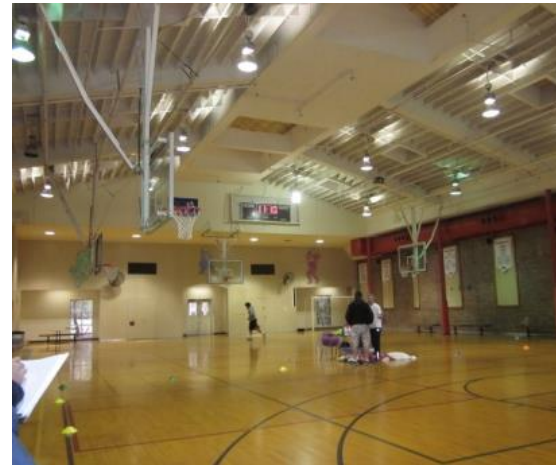
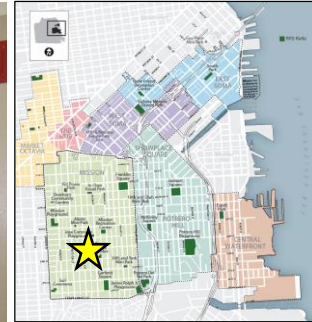

Impact Fees:
\$3,740,000

Next Steps:
Undertake Feasibility and
Structural Assessment

INVESTING IN OUR PARK SYSTEM LEVERAGED FUNDS

Over the last decade, we invested \$380M in our system through our Bond Program.

PROJECT EXAMPLES

Margaret Hayward Playground



Garfield Pool



Community Opportunity Fund



Let'sPlaySF

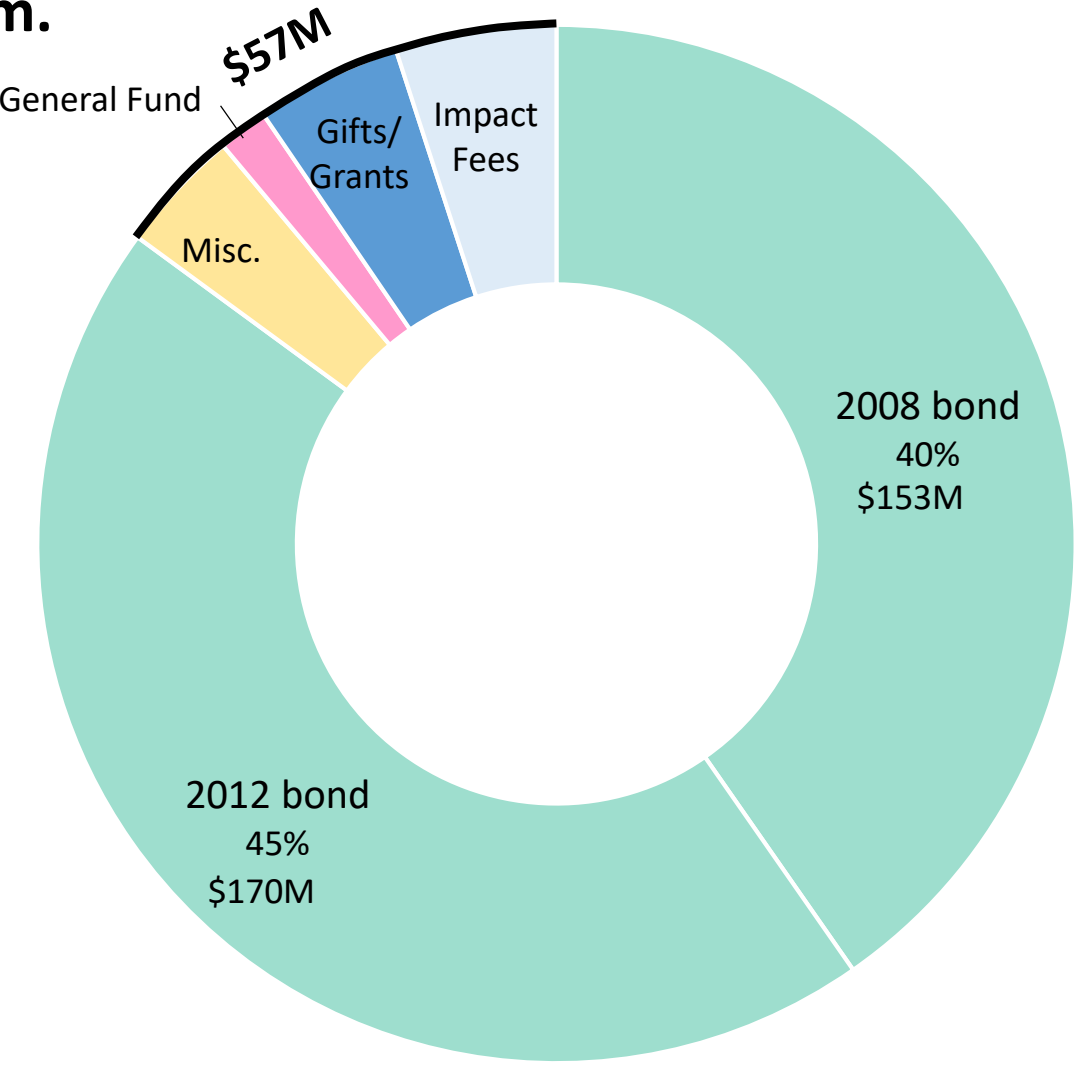
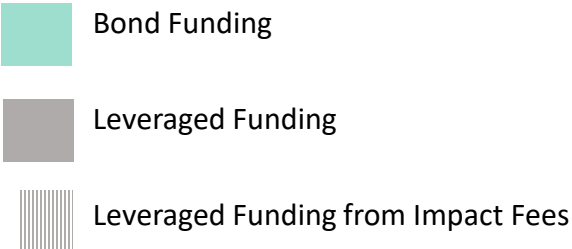

CHALLENGES MORE \$\$, SMALLER SCOPE

\$3.5M *in 2011*

McCoppin Square



Children's Play Areas



Tennis Court



ADA/Landscaping



Basketball Court



Baseball Field



New Restroom

vs.

\$3M *in 2017*

Mountain Lake



Children's Play Area

CHALLENGES CURB-TO-CURB PROJECTS

CURB-TO-CURB



Palega Rec Center

OVER TIME

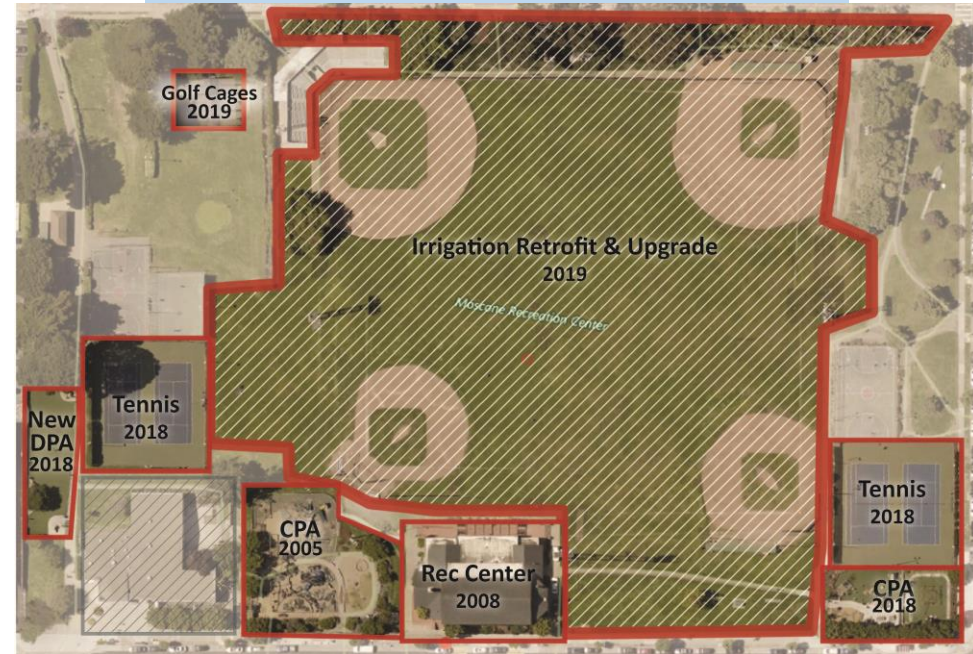

Moscone Playground

 renovated



NOTE: Properties are not the same scale

San Francisco Recreation and Park Department



Today's Projects Will Cost Significantly More

To mitigate the risks and be able to deliver projects & programs, planning for this bond will include:

- ☐ Robust Advance Planning to Mitigate Risks
- ☐ Healthy Project & Program Reserves/Contingencies



**Deeper
Analysis**



**Existing
Conditions**



INVESTING IN OUR FUTURE GROWTH, EQUITY, CONDITION



High Needs

Density ➔ Equity Zones Growth



Condition Assessment

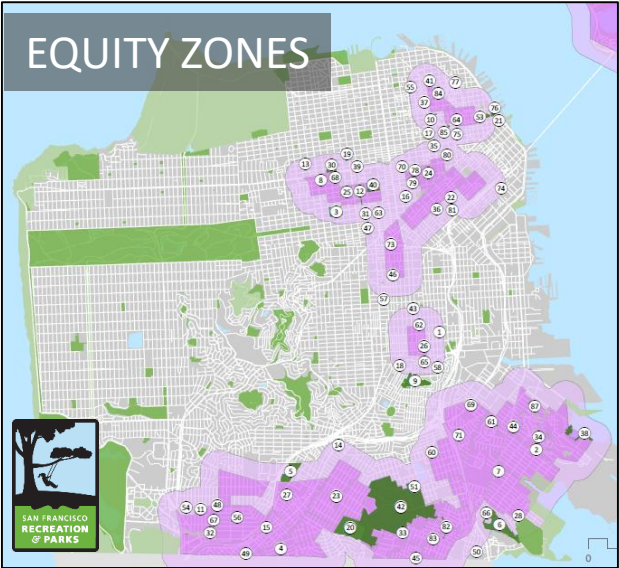

Multi-use Sites/
Community Hubs



Seismic Safety

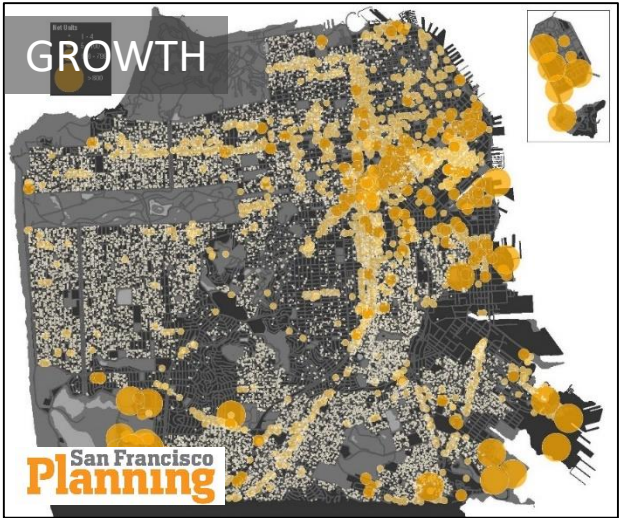

2020 BOND PLANNING PROJECTS & PROGRAMS

projects



Neighborhood Parks



Named Projects



programs



Community
Opportunity
Fund (COF)



Children's
Play Areas



Citywide Parks

Golden Gate Park
McLaren Park
Lake Merced



Community
Gardens



Mini Parks



Water
Conservation



Urban
Forestry



Sustainability



Trails



2020 BOND PLANNING SCHEDULE OVERVIEW

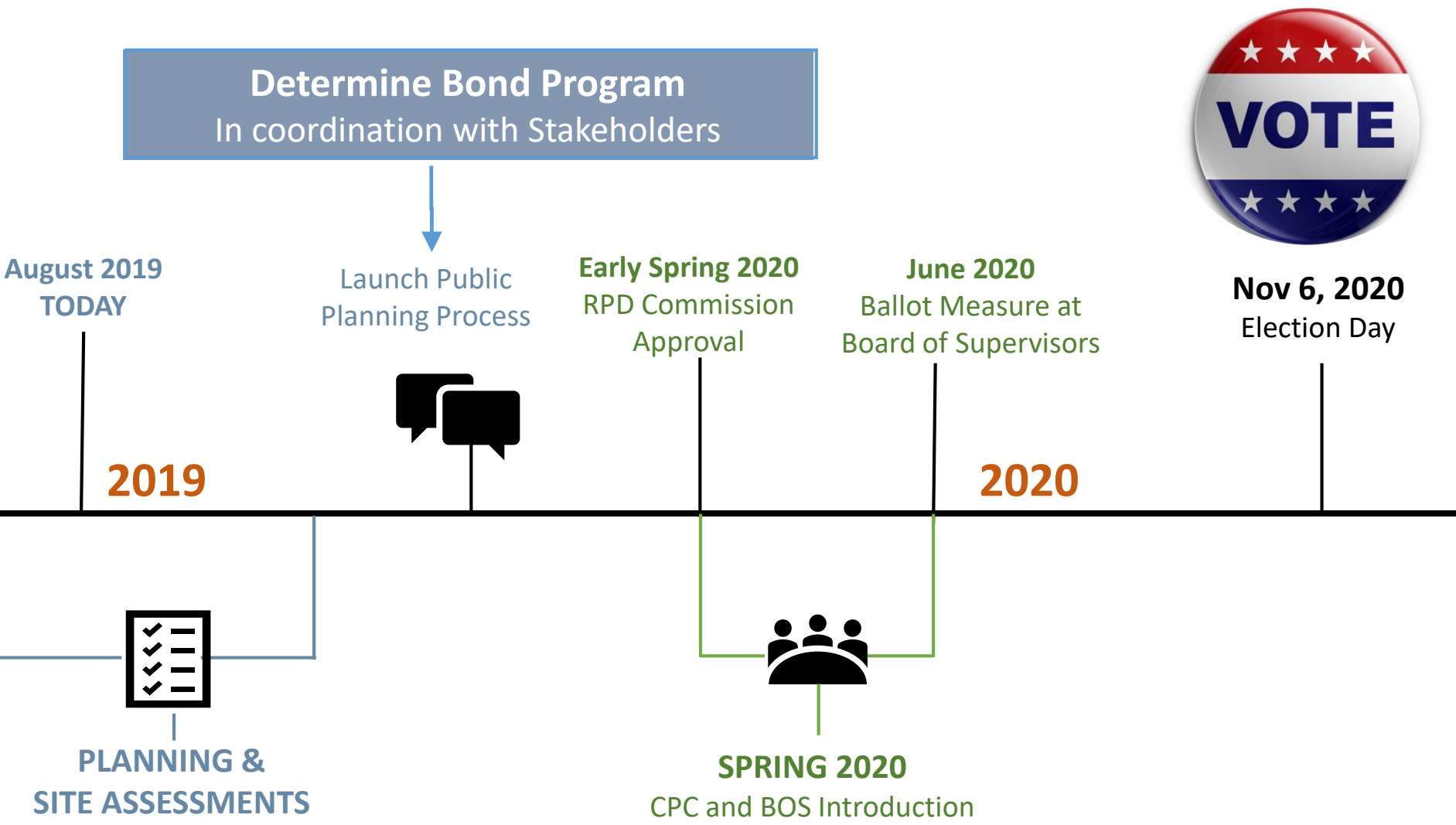



Thank You

